



Automatic Watch Winder
vr001
vr002

Instruction Manual

content	page
AC OPERATION	2
LOADING THE WATCH ON THE WATCH PILLOW	3
PLACING YOUR WATCH TO THE WINDER	4
MODES OF WINDING	5
TURN ON THE POWER	6
MODES SPECIFICATIONS	7
MAINTENANCE	8

AC OPERATION

Plug in the AC power adapter to the wall and insert the DC power jack into the back of the unit.

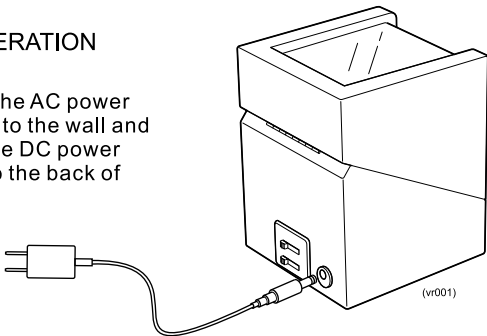

Note: Disconnect the AC power adapter when the winder is not in use.

LOADING THE WATCH ON THE WATCH PILLOW

Take out the watch pillow and squeeze it to a suitable size, then fasten the watch on it.

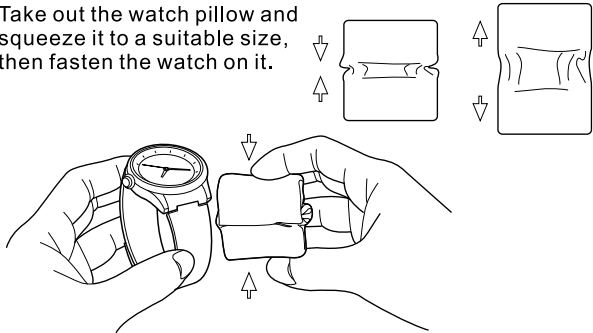

PLACING YOUR WATCH TO THE WINDER

Insert watch and watch pillow into the watch winder holder.

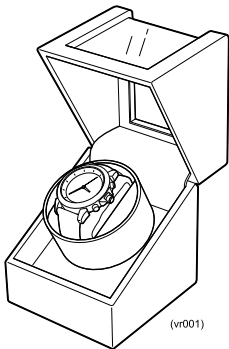

(vr001)

MODES OF WINDING

Slide the switches to select the winding modes.

There are 4 turning modes (TPD - turns per day) and 3 direction modes (clockwise, counterclockwise and both directions) to wind your watch.

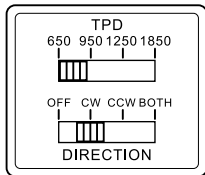

TURN ON THE POWER

Slide the switch from OFF to the right to turn on the watch winder and start winding.

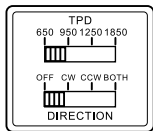

POWER OFF

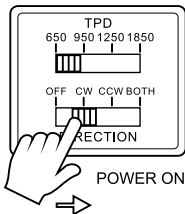

POWER ON

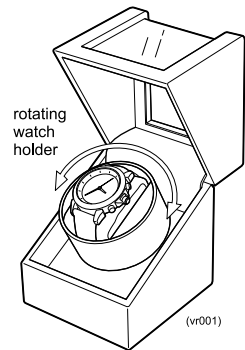

MODES SPECIFICATIONS

TPD	Clockwise winding	Counterclockwise winding	Clockwise/ counterclockwise winding	Resting time (one direction/ both directions)
650	1 min	1 min	1 min/1 min	14.5 min/29 min
950	1 min	1 min	1 min/1 min	9.5 min/19 min
1250	1 min	1 min	1 min/1 min	7 min/14 min
1850	1 min	1 min	1 min/1 min	4.5 min/9 min

Values may vary depending on the weight of different watches.

MAINTENANCE

Do not expose the watch winder to direct sunlight, extreme temperatures, water, or other moisture which may damage the winder.

Clean the winder surfaces with the microfiber pouch that comes with the package.

Do not use solvent-based cleaning agents.

Please do not open the watch winder or attempt to repair it.